

# LabSmith 8-Position Selector Valve Specifications

- Small footprint
- One common port and eight selector ports
- Compatible with wide range of chemicals
- Low valve volume
- Innovative software for coordinated control
- Direct connection to 360 mm or 1/16" tubing



Model	Internal Volume	Through Hole Diameter	Wetted Material	Capillary or Tubing Interface
AV801-C360V AV801-C360K	370 nl	0.01" (250 µm)	Vespel PCTFE	360 µm OD (via p/n C360-100)
AV801-T116V AV801-T116K	2.8 ul	0.02" (500 µm)	Vespel PCTFE	1/16" OD (via p/n T116-100)

Valve Specifications	
Wetted material	Vespel® or PCTFE (commonly known as Kel-F®)
Switch time	1.25—2.75 s (time depends on whether ports are adjacent or spaced). Note: valve switches in counter clock-wise direction only. Switching from port 1 -> 2, switch time = 1.25 sec switching from port 2 -> 1, switch time = 2.75 sec
Actuation method	gear motor
Cleaning	flush valve ports with DI water or solvent
Service temperature range	50 — 176°F (10 — 80°C)
Maximum operating pressure	5000 psi (34 MPa)
Electrical connection	connects to 4VM02 or 1DSL via flat flex ribbon cable

Valve Accessories	
4VM02	electronic manifold for controlling up to 4 automated valves with uProcess system
1DSL	electronic manifold for controlling 1 automated valve, 1 analog sensor, and 1 stepper-motor motion stage.
EIB200	for communication with 4VM02, 1DSL, and other uProcess devices; includes uProcess™ software, LabVIEW™ drivers, and SDK
uProcess breadboard uPB-05, uPB-08, uPB-12, or iBB	optional platform for mounting AV-series valves, 4VM02, and other microfluidic devices
LS-SCREWS.25	set of 20 thread-forming screws (2-28-1/4") to mount 10 valves or reservoirs to breadboard
One-piece fittings C360-100 or T116-100	required for connection to capillary or tubing

# LabSmith 8-Positon Selector Valve Specifications

## Dimensions:

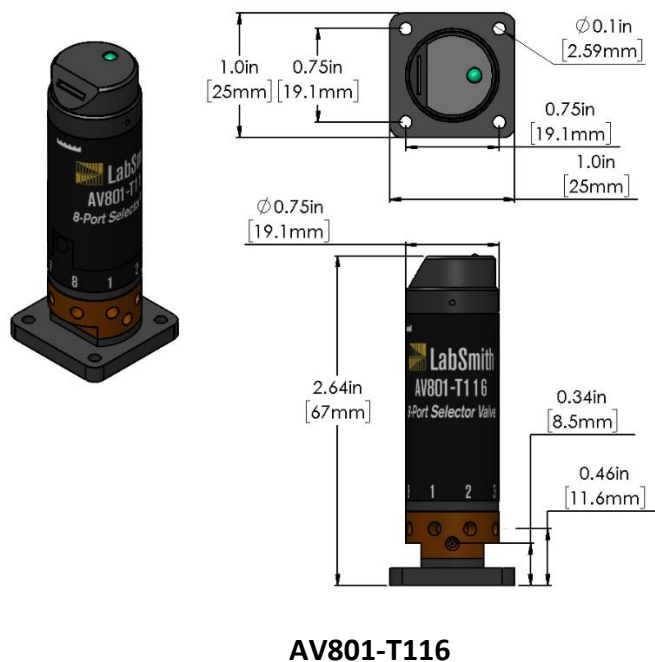
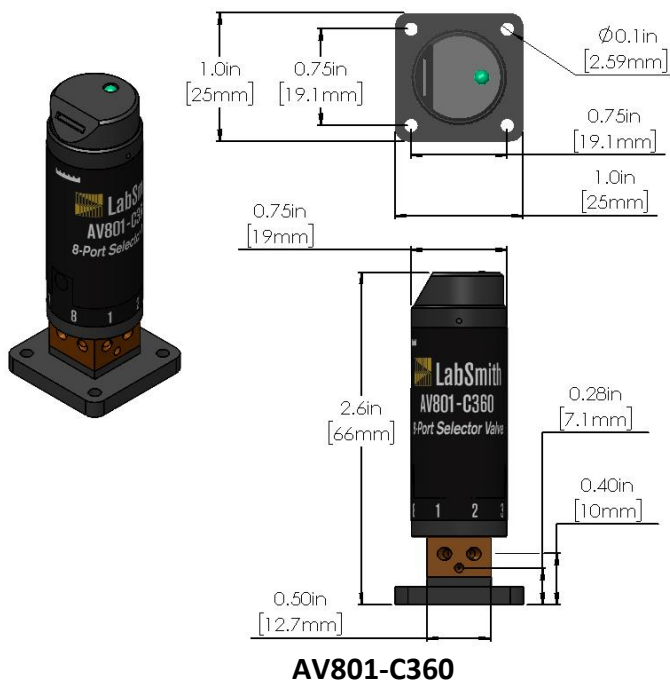

## Internal port configurations:

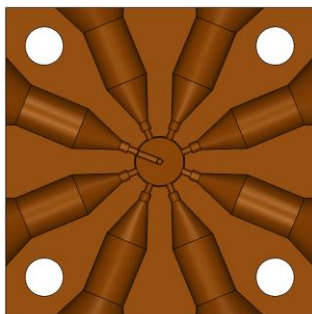

top view showing selector ports

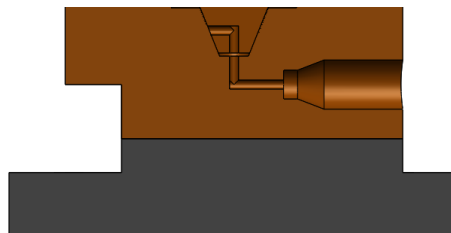

side view showing common port and stem